

TOL. UNLESS OTHERWISE NOTED (IN.)

VA. END-TO-END LENGTH: $\frac{1}{8}$ "

OTHER VA. DIM.: \leq NPS 2", $\frac{1}{16}$ "

NPS $\frac{3}{4}$ "~4", $\frac{1}{32}$ "; >4", $\frac{1}{16}$ "

VA.-ACT. ASSY & PIPING DIM.: $\frac{1}{16}$ "

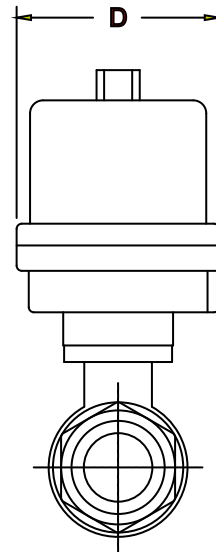
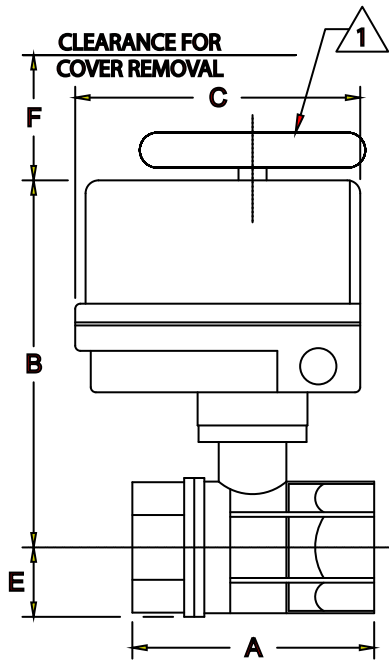

1 MANUAL OVER-RIDE HANDWHEEL PROVIDED ONLY ON ACTUATORS ER-4-10-4 & ER-10-15-4.

2 INCLUDES 2.00" HIGH BRACKET

SIZE	ACTUATOR	DIMENSIONS (INCHES)						WT.(LBS)
		A	B	C	D	E	F	
1/4"-1/2"	ER-1-2-4	2.63	5.43	5.63	4.00	0.66	2.5	6
3/4"	ER-1-2-4	2.99	5.50	5.63	4.00	0.78	2.5	6
1"	ER-1-2-4	3.34	5.84	5.63	4.00	0.96	2.5	6
1 1/4"	ER-1-2-4	3.66	5.90	5.63	4.00	1.15	2.5	7
1 1/2"	ER-2-5-4	4.13	7.36	6.88	4.25	1.40	3.0	10
2"	ER-2-5-4	4.80	7.72	6.88	4.25	1.80	3.0	12
2 1/2"	ER-4-10-4	6.10	11.95	$\frac{2}{16}$ 7.00	7.00	2.22	4.0	23
3"	ER-4-10-4	6.88	12.33	$\frac{2}{16}$ 7.00	7.00	2.66	4.0	27
4"	ER-10-15-4	8.04	10.60	7.00	7.00	3.26	4.0	30

MAX. DIFF. PRESSURE ACROSS VALVE

SEAT MATERIAL-TEFLON

DIMENSIONS GIVEN FOR NEMA 4 ENCLOSURE

CUSTOMER ORDER # _____

CUSTOMER _____

TAG No. _____

SIZE & MODEL # 1/4" - 4" FULL PORT DM-600

W/ ER ELECTRIC ACTUATOR

CERTIFIED _____ DATE _____



a division of Richards Industries

CINCINNATI, OHIO U.S.A

www.marwinvalve.com

DRAWN BY	DATE
DW	3/27/03
CHECKED BY	DATE

MD60004