

A	ADDED 1500#	1/8/07	DB
B	MEC 10013	5/28/10	DW

NOTE: FACE-TO-FACE
 DIMENSION "A" COMPLIES WITH
 ASME B16.10 EXCEPT 2 1/2"R-
 4"R CLASS 150 IS SAME AS
 CLASS 300.

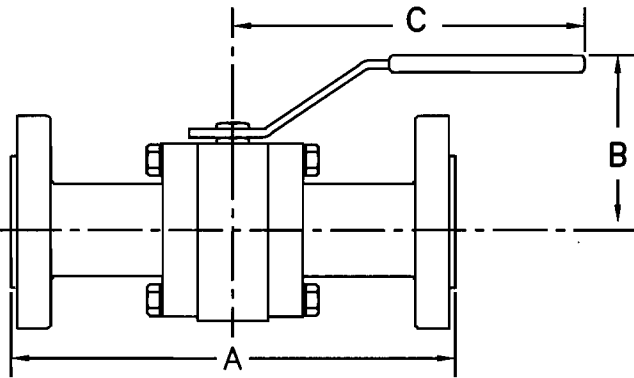

SIZE	DIMENSIONS IN INCHES			
	FLANGE	A	B	C
1/2"R	150#	4.25	2.64	5.98
	300#	5.50	2.64	5.98
	600#	6.50	2.64	5.98
	900/1500#	8.50	2.64	5.98
3/4"R	150#	4.62	2.76	5.98
	300#	6.50	2.76	5.98
	600#	7.50	2.76	5.98
	900/1500#	9.00	2.76	5.98
1"R	150#	5.00	3.15	7.60
	300#	6.50	3.15	7.60
	600#	8.50	3.15	7.60
	900/1500#	10.00	3.15	7.60
1 1/4"R	150#	5.50	3.62	7.60
	300#	7.00	3.62	7.60
	600#	9.00	3.62	7.60
	900/1500#	11.00	3.62	7.60
1 1/2"R	150#	6.50	4.25	8.86
	300#	7.50	4.25	8.86
	600#	9.50	4.25	8.86
	900/1500#	12.00	4.25	8.86
2"R	150#	7.00	4.45	8.86
	300#	8.50	4.45	8.86
	600#	11.50	4.45	8.86
	900/1500#	14.50	4.45	8.86
2 1/2"R	150#	*9.50 (B)	4.65	8.86
	300#	9.50	4.65	8.86
	600#	13.00	4.65	8.86
3"R	150#	**11.12 (B)	5.35	13.80
	300#	11.12	5.35	13.80
	600#	14.00	5.35	13.80
4"R	150#	***12.00 (B)	5.91	19.70
	300#	12.00	5.91	19.70
	600#	17.00	5.91	19.70

(B) *2.5"R WAS 7.50 PRIOR TO
 APR. 2010

(B) **3" WAS 8.00 PRIOR TO
 APR. 2010

(B) ***4"R WAS 9.00 PRIOR TO
 APR. 2010

CUSTOMER ORDER # _____

CUSTOMER _____

TAG No. _____

SIZE & MODEL # 1/2-4" 3000/7000R

150#, 300#, 600#, 900# F.E.

CERTIFIED _____ DATE _____

MARWINVALVE

a division of Richards Industries
 CINCINNATI, OHIO U.S.A

www.marwinvalve.com

DR. BY JLW 07/09/03

CHK. BY _____

MD03114